

Shuttle Valve & Double Pressure Valve

Symbol

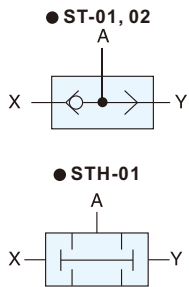

Features

Shuttle valve

1. Check ball moves from high pressure inlet to low pressure inlet.
2. The valve provides two inlets for air supply.
3. Available port sizes G1/8", 1/4".

Double pressure valve

1. The valve provides X and Y inlet for double pressure supply.



How to order

ST	—	01	N
ST	: Shuttle valve	Port size	Thread
STH	: Double pressure valve	01 : 1/8" 02 : 1/4"	Blank : G N : NPS R : Rc

Specifications

Model	ST-01	ST-02	STH-01
Port size	1/8"	1/4"	1/8"
Body material	Aluminum alloy		
Fluid	Compressed air		
Sectional area	7.5mm ²	21mm ²	14mm ²
Operating pressure range	1 ~ 9.9 kgf/cm ²		
Proof pressure	10 kgf/cm ²		
Ambient temperature	-10°C ~ 80°C		
Max. flow rate (l/min)	823	1583	857

Dimensions

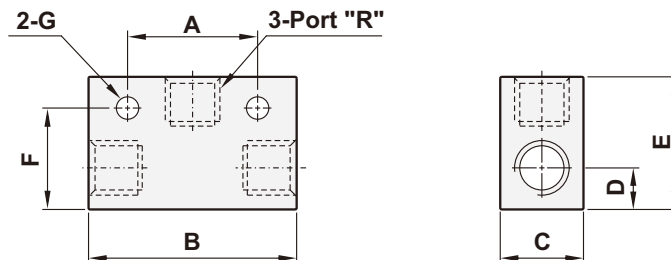

Model	R	A	B	C	D	E	F	G
STH-01	1/8"	25	40	16	8	25.4	19.4	φ 4.3
ST-01	1/8"	25	40	16	8	25.4	19.5	φ 4.3
ST-02	1/4"	35	52	22	11	35	25	φ 5.5