



■ PU tube

Model	O.D. (mm)	I.D. (mm)	Break pressure (kgf/cm ²)	Length per roll (m)
PU-0320	3	2	15	200
PU-0425	4	2.5	18	200
PU-0640	6	4	20	200
PU-0850	8	5	20	100
PU-1065	10	6.5	20	100
PU-1180	11	8	18	100
PU-1280	12	8	20	100
PU-1612	16	12	20	50
PU-1613	16	13	18	50
PU-1/4	6.35	4.2	20	200
PU-3/8	9.53	6.5	18	100
PU-1/2	12.6	9.6	18	100

■ Color of PU tube

Standard color: Blue, Black, Orange
Optional color: Red, Yellow, Transparent, Green

Standard color	Code	Optional color	Code
Blue	BL	Yellow	Y
Black	B	Transparent	T
Orange	OR	Red	R
		Green	G

■ Nylon tube

Model	O.D. (mm)	I.D. (mm)	Break pressure (kgf/cm ²)	Length per roll (m)
NY-0420	4	2	50	200
NY-0425	4	2.5	50	200
NY-0640	6	4	50	100
NY-0860	8	6	50	100
NY-1075	10	7.5	50	100
NY-1290	12	9.0	50	100
NY-1/4	6.35	4.57	45	100
NY-3/8	9.53	6.99	45	100
NY-1/2	12.6	9.53	50	100

■ Color of Nylon tube

Standard color: Black, Milk white

Standard color	Code
Milk white	W
Black	B

*NY-0420 is unavailable for black.

Air Hose Reel

■ Features

- Close Version.
- High quality special plastic material, durable construction.
- PU Hose.
- Stainless springs.
- Steel quick coupler.



Model No.	HR-108	HR-110	HR-208	*HR-115	HR-212	HR-308
Case	Plastic					
Hose Size (ID Inch)	8x5mm		10x6.5mm (1/4")	8x5mm	10x6.5mm (1/4")	12x8mm (5/16")
Working Pressure	100 Psi (7 kg/cm ²)					
Burst Pressure	380 Psi (25 kg/cm ²)					
Hose Length	8M	10M	8M	15M	12M	8M
Hose Type	PU Hose					
Hose Color	Blue		Red	Blue	Red	Blue
Case Color	Blue				Red	Blue
Inlet/Outlet	1/4"					
Working Temperature	0°C ~ 50°C					
Weight	2.5kg			3kg		
Packing (LxWxH)	265mm X 290mm X 80mm			320mm X 310mm X 90mm		

*customized products

■ Features

- Close Version.
- Heavy duty reinforced steel construction with paint coating
- PU Braid Hose.
- Stainless springs.
- Steel quick coupler.



Model No.	HR-115S	HR-215S	HR-312S	HR-220S	HR-320S	HR-518S
Case	Steel					
Hose Size (ID Inch)	8x5mm	10x6.5mm (1/4")	12x8mm (5/16")	10x6.5mm (1/4")	12x8mm (5/16")	13.5x9.5mm (3/8")
Working Pressure	220 Psi (15 kg/cm ²)					
Burst Pressure	880 Psi (60 kg/cm ²)					
Hose Length	15M		12M	20M		18M
Hose Type	PU Braid Hose					
Hose Color	Blue					
Case Color	Red			Gray		
Inlet/Outlet	1/4"					3/8"
Working Temperature	0°C ~ 60°C					
Weight	6kg			8.5kg		
Packing (LxWxH)	355mm X 285mm X 160mm			415mm X 330mm X 185mm		

DA Series Shock Absorber

Features

1. Hydraulic self compensation.
2. Adjustable cushion.
3. Double cushion type.
4. Simple installation.

Installation cautions

1. Stop at 1mm before effective stroke.
2. Avoid any painting or damage on rod.
3. Strike angle on the collision head should be at right 90°, or less than 2° difference.
4. Please pay attention for the hardness of mounting plate to stand the strike.



How to order

DA	25	25 - H	NC	P	
Shock absorber	Tube O.D.	Stroke	Impact speed	Cap	Positioning screw
DA : Self compensation type DAD : Double cushion type CA : Adjustable type			H: High impact speed N: Medium impact speed L: Low impact speed *Available for DA, DAD only	Blank : W/I cap NC : W/O cap	Blank : W/O positioning screw P : W/I positioning screw

Dimensions

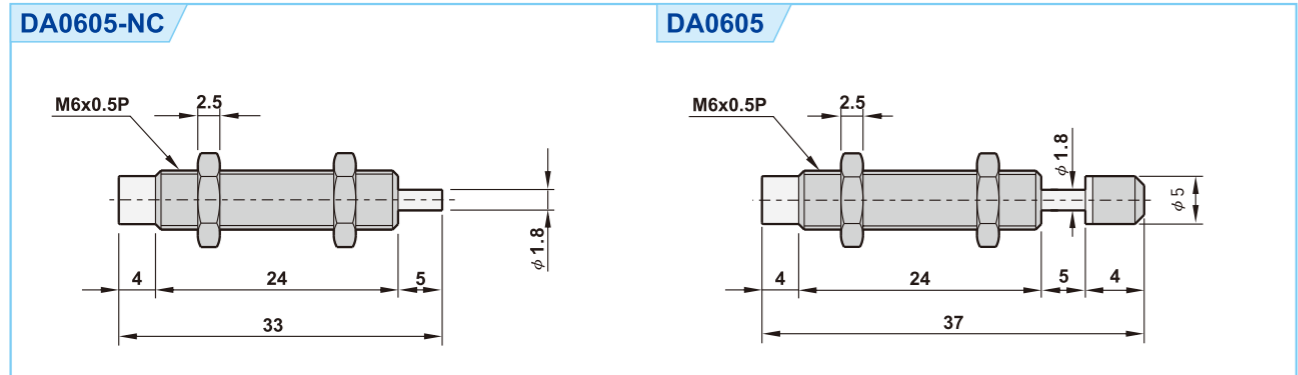

Model no.	Stroke mm	Max. Nm per cycle Nm	Effective weight We(Kg)	Max impact speed m/s	Max. Nm per hour Nm	Operating temperature °C
DA0605-H	5	0.9	0.6~2.8	1.8	1920	-10~70
DA0605-N	5	0.9	1.25~3.7	1.2	1920	-10~70

Dimensions

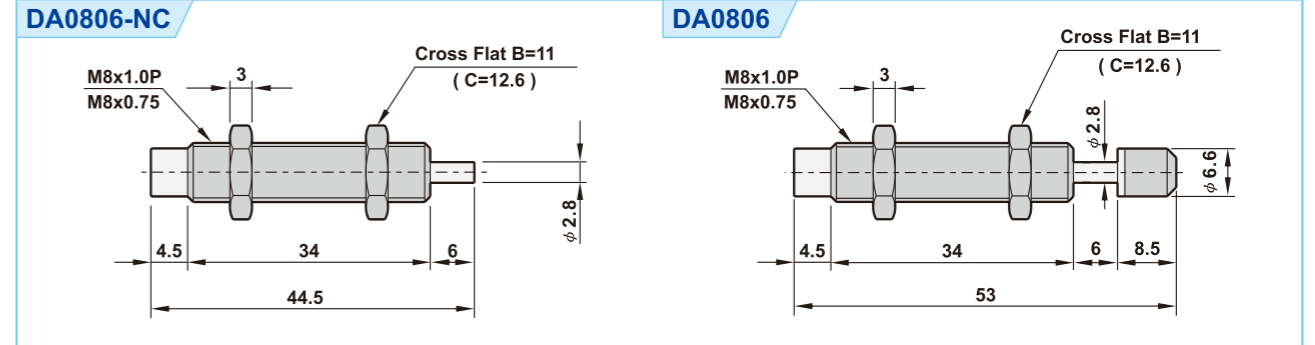

Model no.	Stroke mm	Max. Nm per cycle Nm	Effective weight We(Kg)	Max impact speed m/s	Max. Nm per hour Nm	Operating temperature °C
DA0806-H	6	1.8	0.9~5.6	2	4320	-10~70
DA0806-N	6	1.8	2.5~10	1.2	4320	-10~70
DA0806-L	6	1.8	5.6~22.5	0.8	4320	-10~70

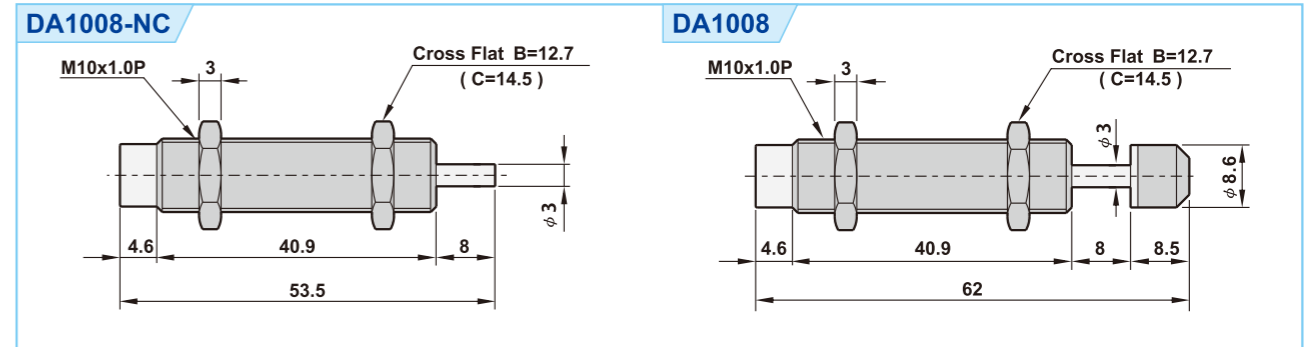

Model no.	Stroke mm	Max. Nm per cycle Nm	Effective weight We(Kg)	Max impact speed m/s	Max. Nm per hour Nm	Operating temperature °C
DA1008-H	8	3.2	0.9~10	2.6	7680	-10~70
DA1008-N	8	3.2	2.8~17.8	1.5	7680	-10~70
DA1008-L	8	3.2	10~40	0.8	7680	-10~70

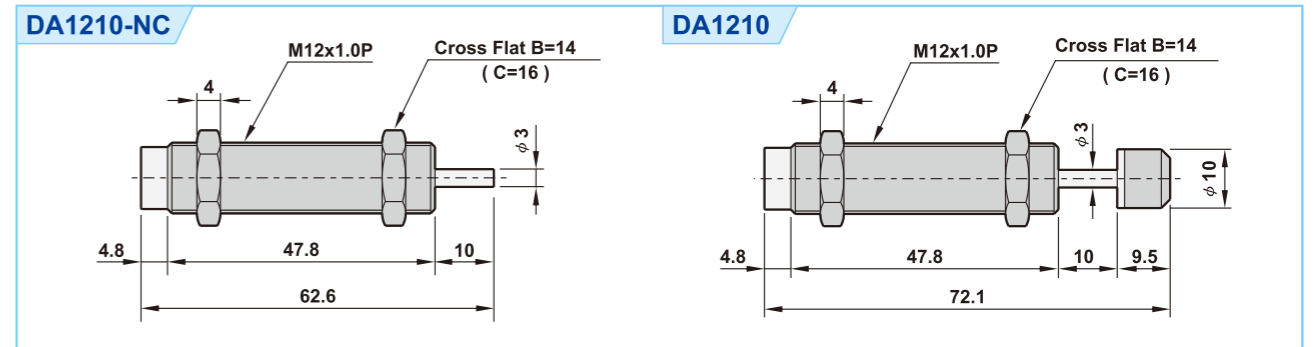

Model no.	Stroke mm	Max. Nm per cycle Nm	Effective weight We(Kg)	Max impact speed m/s	Max. Nm per hour Nm	Operating temperature °C
DA1210-H	10	6	1.8~18.8	2.6	14400	-10~70
DA1210-N	10	6	5.3~33	1.5	14400	-10~70
DA1210-L	10	6	12~75	0.8	14400	-10~70

Accessories

Coil

Coil

Connector

Ex-Proof Coil

Fitting

Sleeve Coil

P/NU Tube

DA

Customized Column

■ Dimensions

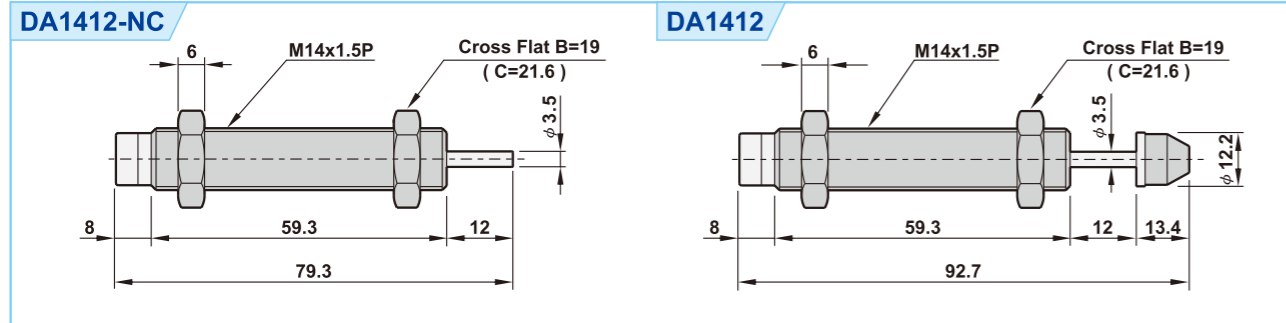

Model no.	Stroke mm	Max. Nm per cycle Nm	Effective weight We(Kg)	Max impact speed m/s	Max. Nm per hour Nm	Operating temperature °C
DA1412-H	12	16	4.7~32	2.6	28800	-10~70
DA1412-N	12	16	14~65	1.5	28800	-10~70
DA1412-L	12	16	56~200	0.8	28800	-10~70

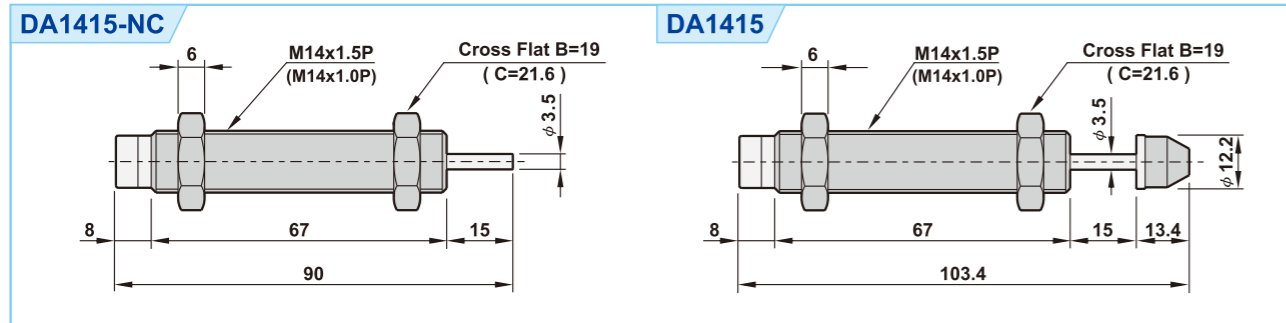

Model no.	Stroke mm	Max. Nm per cycle Nm	Effective weight We(Kg)	Max impact speed m/s	Max. Nm per hour Nm	Operating temperature °C
DA1415-H	15	20	5.9~40	2.6	36000	-10~70
DA1415-N	15	20	17.8~81.6	1.5	36000	-10~70
DA1415-L	15	20	62.5~250	0.8	36000	-10~70

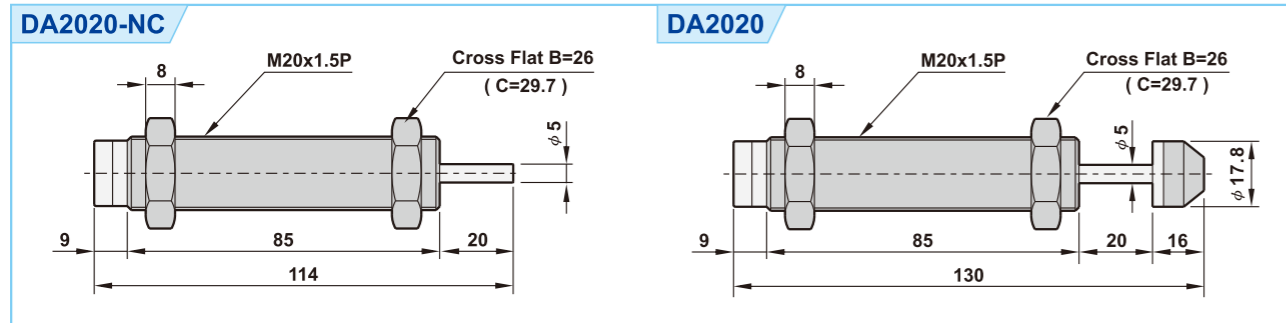

Model no.	Stroke mm	Max. Nm per cycle Nm	Effective weight We(Kg)	Max impact speed m/s	Max. Nm per hour Nm	Operating temperature °C
DA2020-H	20	35	6.8~27	3.2	42000	-10~70
DA2020-N	20	35	17.5~70	2	42000	-10~70
DA2020-L	20	35	48.6~777	1	42000	-10~70

■ Dimensions

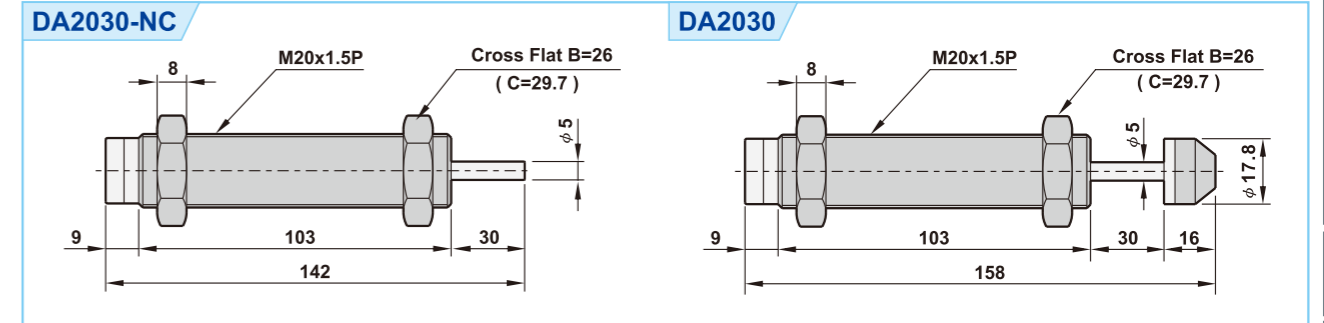

Model no.	Stroke mm	Max. Nm per cycle Nm	Effective weight We(Kg)	Max impact speed m/s	Max. Nm per hour Nm	Operating temperature °C
DA2030-H	30	46	9~36	3.2	55200	-10~70
DA2030-N	30	46	23~92	2	55200	-10~70
DA2030-L	30	46	64~575	1.2	55200	-10~70

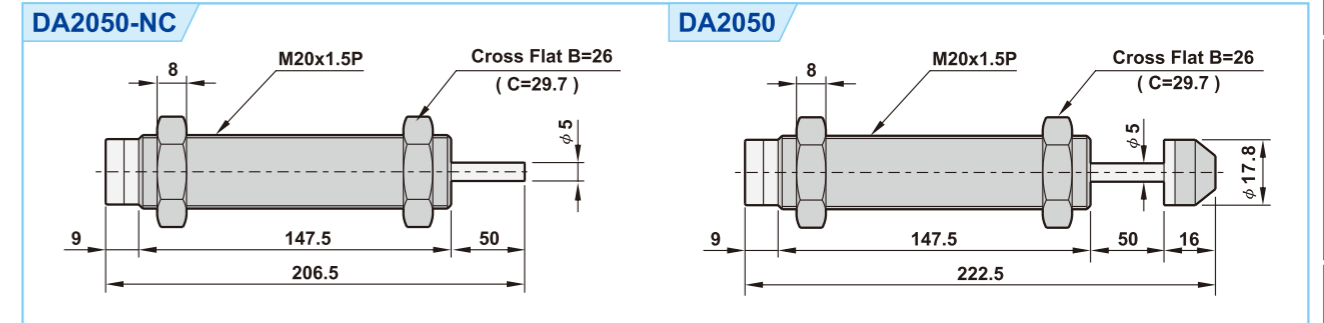

Model no.	Stroke mm	Max. Nm per cycle Nm	Effective weight We(Kg)	Max impact speed m/s	Max. Nm per hour Nm	Operating temperature °C
DA2050-H	50	62	10.1~124	3.5	63240	-10~70
DA2050-N	50	62	18.3~253	2.6	63240	-10~70
DA2050-L	50	62	55~496	1.5	63240	-10~70

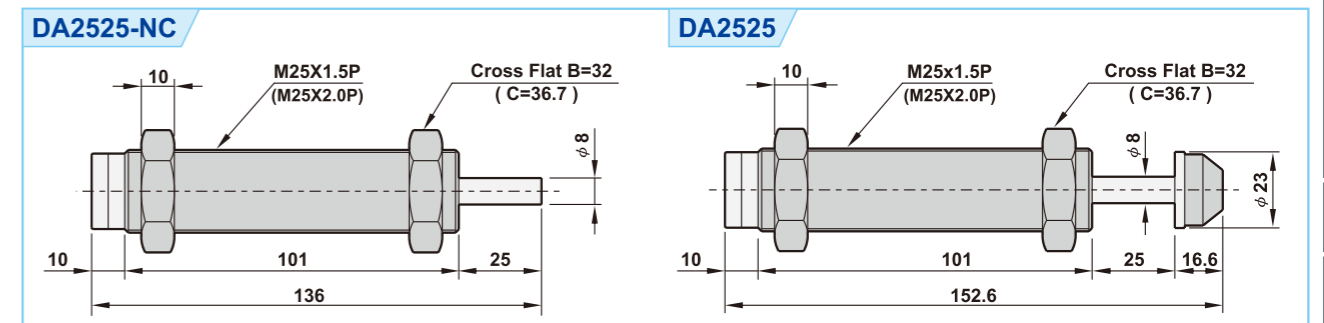

Model no.	Stroke mm	Max. Nm per cycle Nm	Effective weight We(Kg)	Max impact speed m/s	Max. Nm per hour Nm	Operating temperature °C
DA2525-H	25	78	15~69	3.2	70200	-10~70
DA2525-N	25	78	39~433	2	70200	-10~70
DA2525-L	25	78	108~1733	1.2	70200	-10~70

Dimensions

DA2540

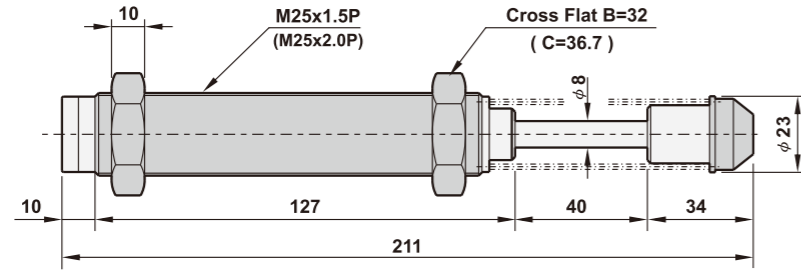

Model no.	Stroke mm	Max. Nm per cycle Nm	Effective weight We(Kg)	Max impact speed m/s	Max. Nm per hour Nm	Operating temperature °C
DA2540-H	40	122	20~108	3.5	87840	-10~70
DA2540-N	40	122	50~381	2.2	87840	-10~70
DA2540-L	40	122	244~1991	1	87840	-10~70

DA2580

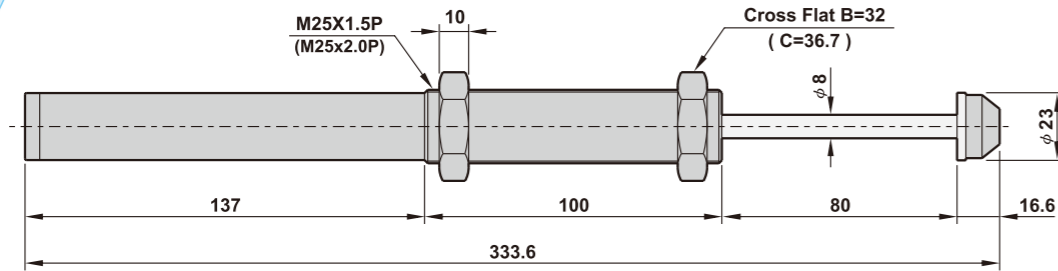

Model no.	Stroke mm	Max. Nm per cycle Nm	Effective weight We(Kg)	Max impact speed m/s	Max. Nm per hour Nm	Operating temperature °C
DA2580-H	80	198	24.7~99	4	118800	-10~70
DA2580-N	80	198	44~396	3	118800	-10~70
DA2580-L	80	198	176~1584	1.5	118800	-10~70

DA3660

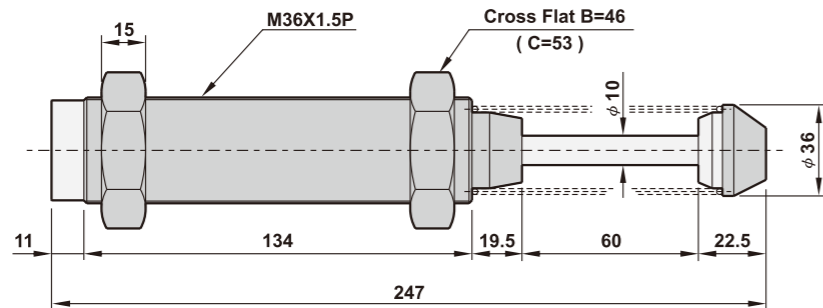

Model no.	Stroke mm	Max. Nm per cycle Nm	Effective weight We(Kg)	Max impact speed m/s	Max. Nm per hour Nm	Operating temperature °C
DA3660-H	60	260	57~231	3	124800	-10~70
DA3660-N	60	260	130~813	2	124800	-10~70
DA3660-L	60	260	520~3520	1	124800	-10~70

Dimensions

DAD2030

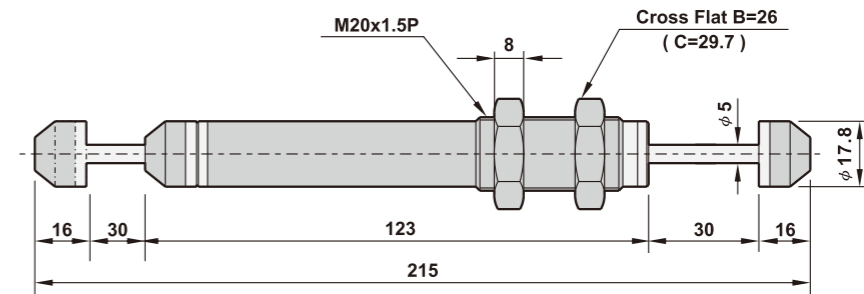

Model no.	Stroke mm	Max. Nm per cycle Nm	Effective weight We(Kg)	Max impact speed m/s	Max. Nm per hour Nm	Operating temperature °C
DAD2030-H	30	46	9~41	3.2	55200	-10~70
DAD2030-N	30	46	23~144	2	55200	-10~70
DAD2030-L	30	46	64~575	1.2	55200	-10~70

DAD2035

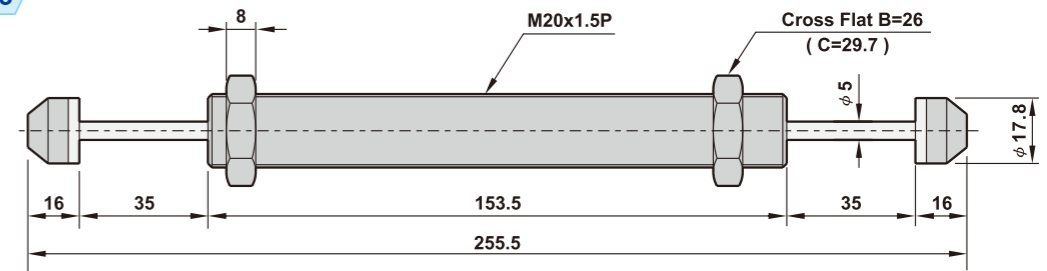

Model no.	Stroke mm	Max. Nm per cycle Nm	Effective weight We(Kg)	Max impact speed m/s	Max. Nm per hour Nm	Operating temperature °C
DAD2035-H	35	52	10~46	3.2	62400	-10~70
DAD2035-N	35	52	26~162	2	62400	-10~70
DAD2035-L	35	52	72~650	1.2	62400	-10~70

DAD2050

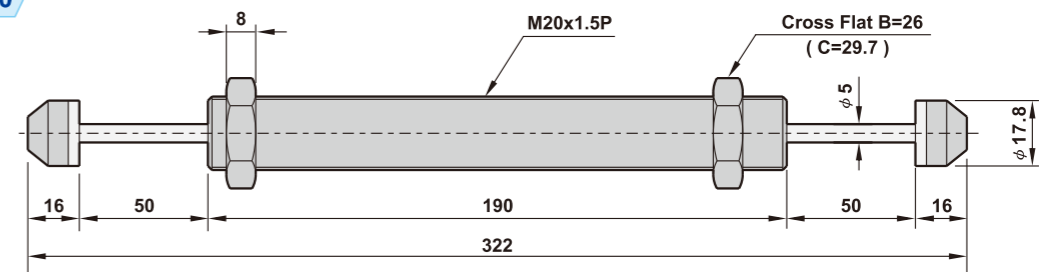

Model no.	Stroke mm	Max. Nm per cycle Nm	Effective weight We(Kg)	Max impact speed m/s	Max. Nm per hour Nm	Operating temperature °C
DAD2050-H	50	62	10.1~124	3	63240	-10~70
DAD2050-N	50	62	18.3~253	2.6	63240	-10~70
DAD2050-L	50	62	55~496	1.5	63240	-10~70

■ Dimensions

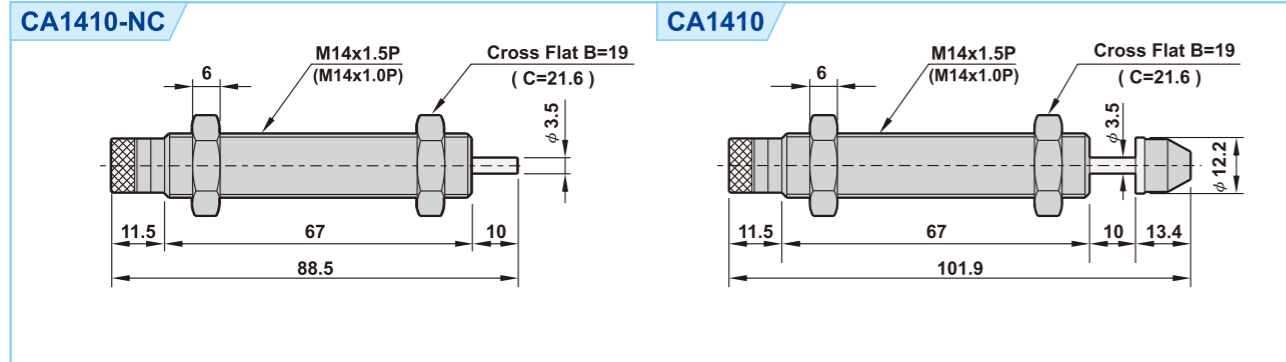

Model no.	Stroke mm	Max. Nm per cycle Nm	Effective weight We(Kg)	Max impact speed m/s	Max. Nm per hour Nm	Operating temperature °C
CA1410	10	15	2.9~120	3.2	27000	-10~70

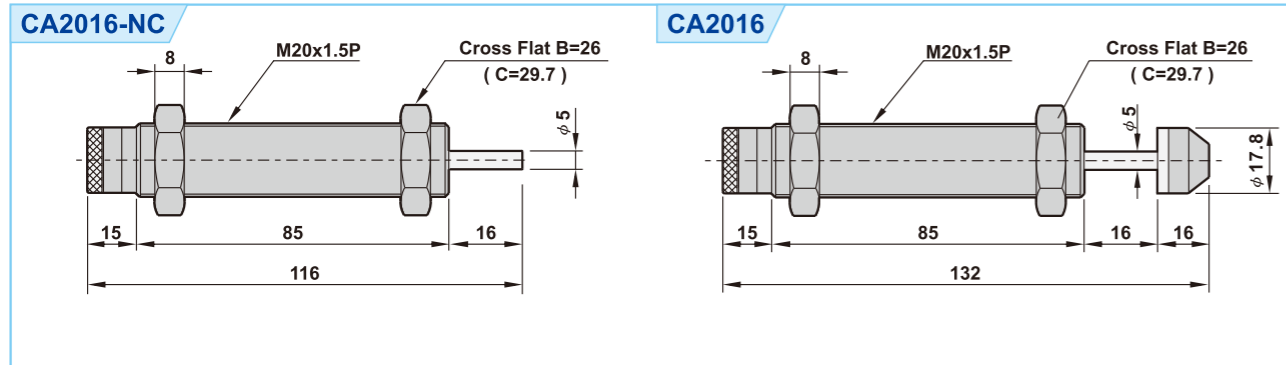

Model no.	Stroke mm	Max. Nm per cycle Nm	Effective weight We(Kg)	Max impact speed m/s	Max. Nm per hour Nm	Operating temperature °C
CA2016	16	28	5.4~224	3.2	33600	-10~70

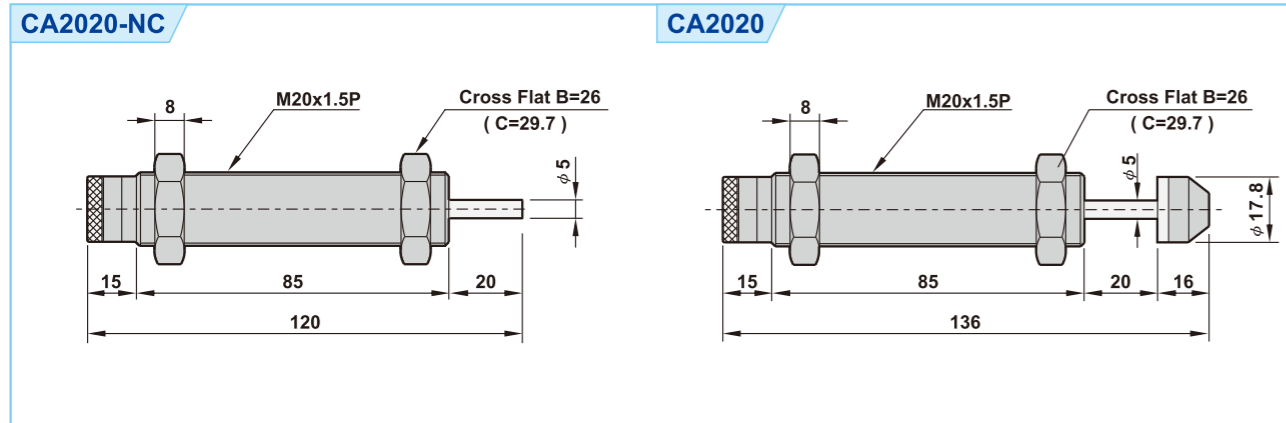

Model no.	Stroke mm	Max. Nm per cycle Nm	Effective weight We(Kg)	Max impact speed m/s	Max. Nm per hour Nm	Operating temperature °C
CA2020	20	35	6.8~280	3.2	42000	-10~70

■ Dimensions

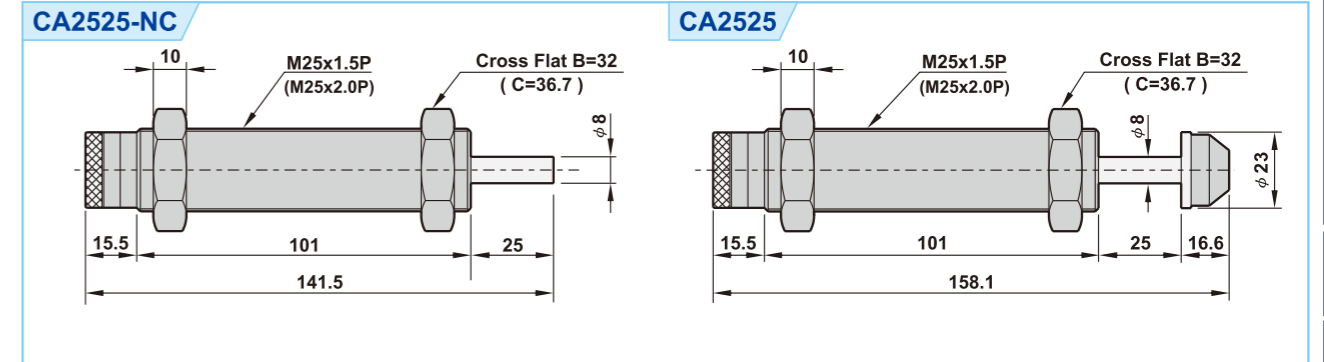

Model no.	Stroke mm	Max. Nm per cycle Nm	Effective weight We(Kg)	Max impact speed m/s	Max. Nm per hour Nm	Operating temperature °C
CA2525	25	78	15~624	3.2	70200	-10~70

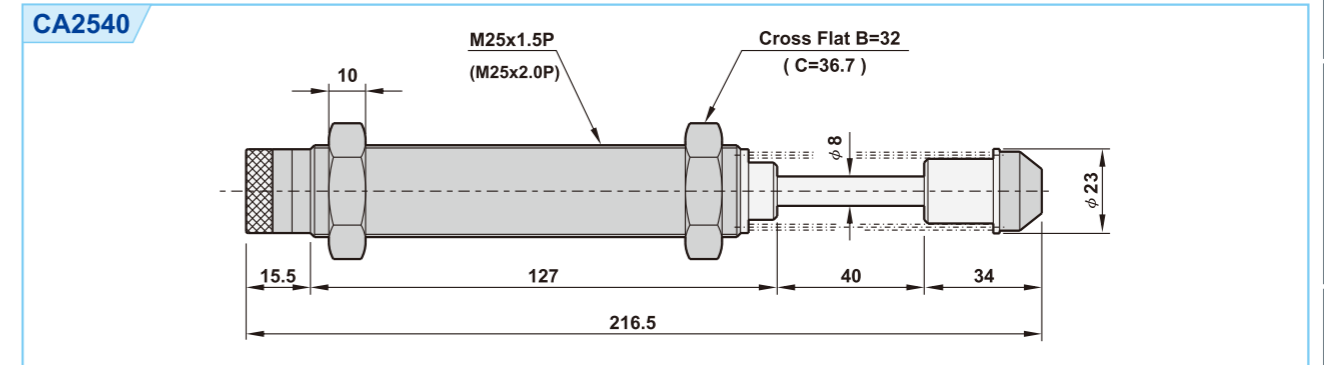

Model no.	Stroke mm	Max. Nm per cycle Nm	Effective weight We(Kg)	Max impact speed m/s	Max. Nm per hour Nm	Operating temperature °C
CA2540	40	122	23.8~976	3.2	87840	-10~70

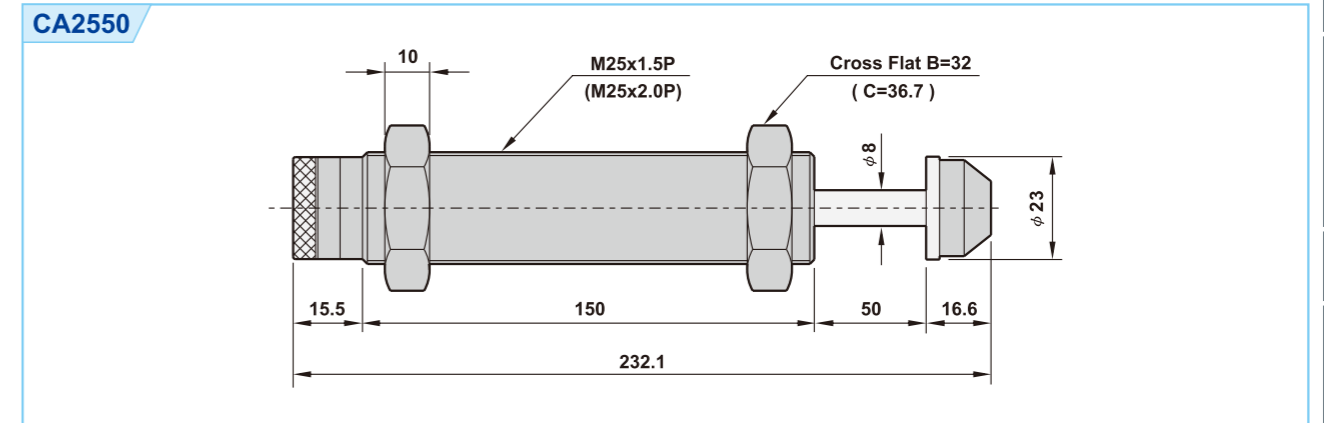

Model no.	Stroke mm	Max. Nm per cycle Nm	Effective weight We(Kg)	Max impact speed m/s	Max. Nm per hour Nm	Operating temperature °C
CA2550	50	140	27~1120	3.2	100800	-10~70

■ Dimensions

CA3625

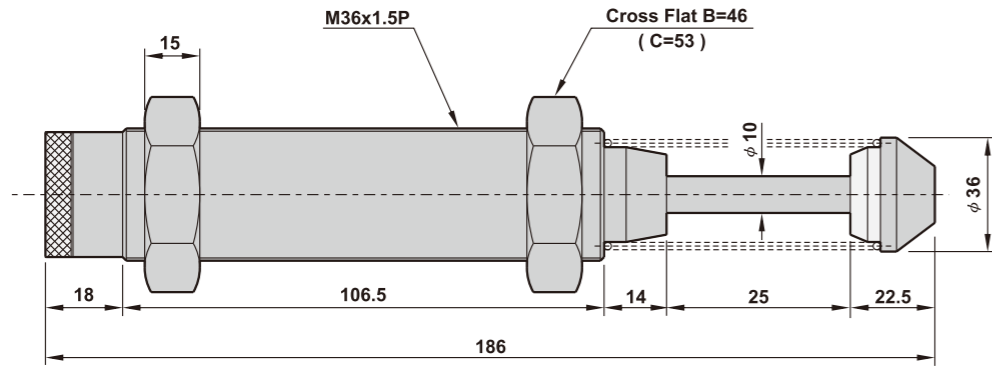

Model no.	Stroke mm	Max. Nm per cycle Nm	Effective weight We(Kg)	Max impact speed m/s	Max. Nm per hour Nm	Operating temperature °C
CA3625	25	110	21~880	3.2	52800	-10~70

CA3650

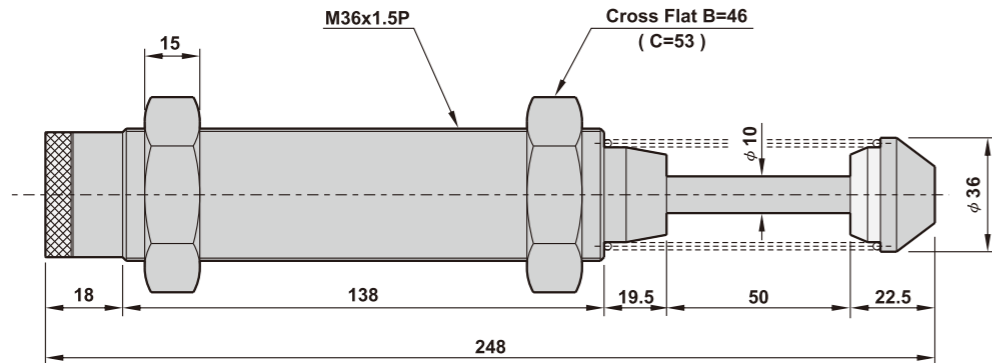

Model no.	Stroke mm	Max. Nm per cycle Nm	Effective weight We(Kg)	Max impact speed m/s	Max. Nm per hour Nm	Operating temperature °C
CA3650	50	220	43~1760	3.2	105600	-10~70

■ Positioning screw-optional accessory

Spec.	Size	For shock absorber	Spec.	Size	For shock absorber
ST08	M8x1.0P M8x0.75 11mm width, 12.6mm height, 15mm length	DA0806	ST20	M20x1.5P 26mm width, 29.7mm height, 25mm length, 36mm total length	DA2020 DA2030 DA2050 CA2016 CA2020 DAD2030 DAD2035 DAD2050
ST10	M10x1.0P 12.7mm width, 14.5mm height, 17mm length	DA1008	ST25	M25x1.5P 32mm width, 36.7mm height, 31.5mm length, 46mm total length	DA2525 CA2525
ST12	M12x1.0P 14mm width, 16mm height, 20mm length	DA1210	ST25L	M25x1.5P (M25x2.0P) 32mm width, 36.7mm height, 31.5mm length, 66mm total length	DA2540 DA2580 CA2540 CA2550
ST14	M14x1.5P (M14x1.0P) 19mm width, 21.6mm height, 18.5mm length, 28mm total length	DA1412 DA1415 CA1410	ST36	M36x1.5P 46mm width, 53mm height, 45mm length, 80mm total length	DA3660 CA3625 CA3650

■ Application diagram for Positioning screw

